



**Science & Technology**  
Facilities Council



Imperial College  
London



**ESS**  
Bilbao



**ASTeC**



THE UNIVERSITY OF  
**WARWICK**

FETS Meeting @ Warwick

# **FETS RFQ Machining Update**

**By P. Savage**

*31<sup>st</sup> July 2013*

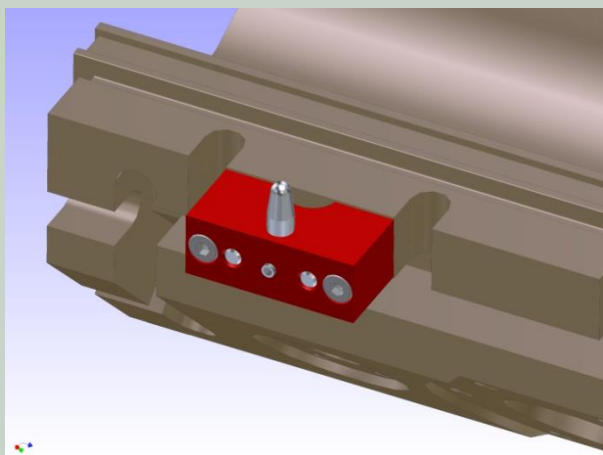

# RFQ alignment blocks

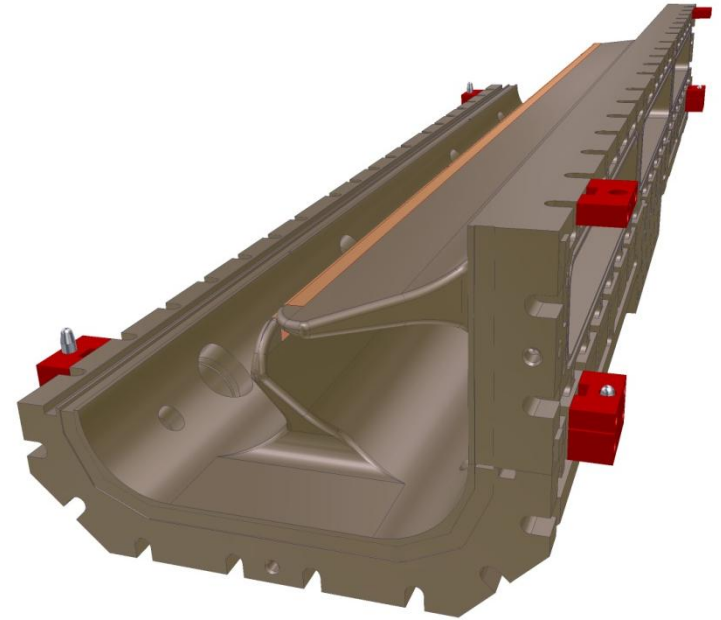
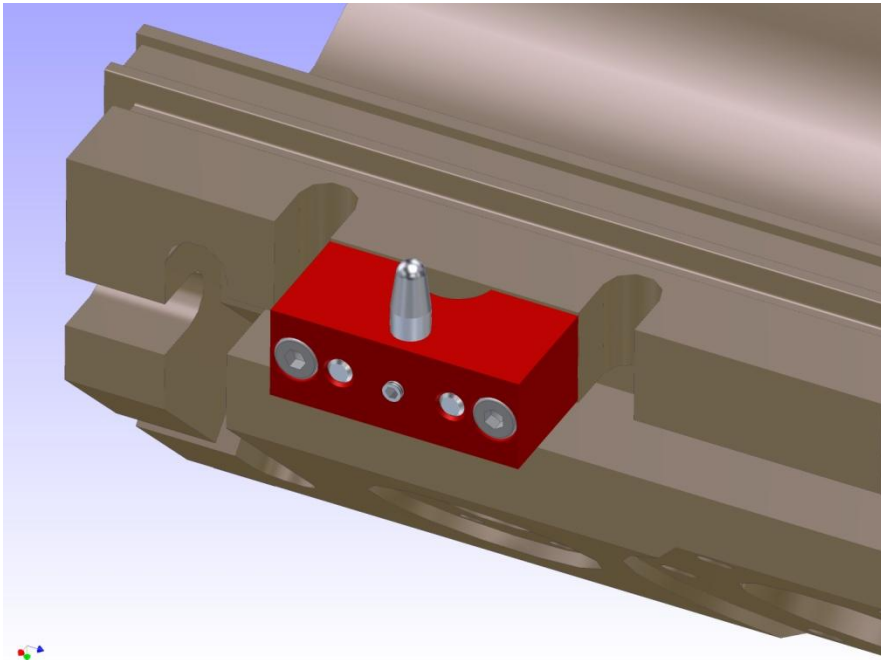

Resources meeting at Imperial to schedule all mechanical (and electrical) work across all projects:

T2K, COMET, LHCb, CMS, SOLID, SuperNEMO, MICE, FETS, Dark Matter,  
LISA Pathfinder

Bottom line is: we are back in production!

# RFQ alignment blocks

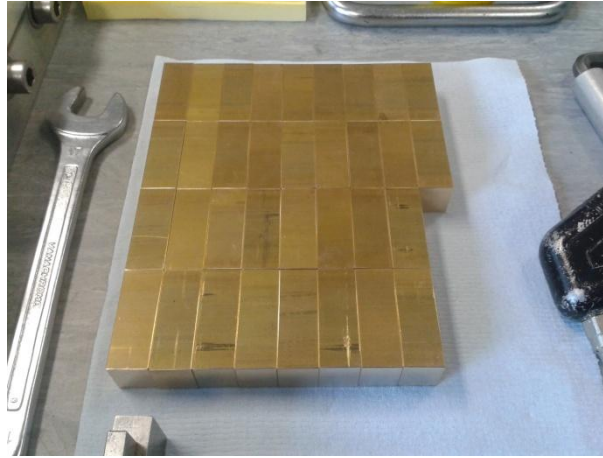

- 40 blocks for major vanes machined to size
- 40 blocks for minor vanes machined to size
- 32 tapered dowels made
- Drilling has started
- Complete end next week

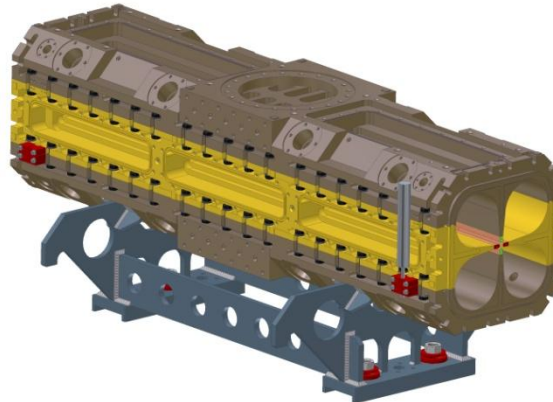

- Pete to deliver to NAB for fitting and drilling

# RFQ update

- Have been assured delivery of RFQ section 1 in August
- Vane machining (with coolant) has been agreed and will commence 3<sup>rd</sup> week in August (following Steve's holidays)

